

# American DJ® MINI MACE



**StarTec**®  
series

## User Instructions

American DJ®  
6122 S. Eastern Ave.  
Los Angeles, CA. 90040  
www.americandj.com

Rev. 1/08

### Mini Mace™

### Introduction

**Introduction:** Thank you for purchasing the Mini Mace™ by American DJ®. The Mini Mace™ is ready to be plugged in right out of the box and does not require any type of controller to operate. The Mini Mace™ comes with two spinning heads that operate on an independently rotating base. This unit produces 30 multi-colored beams of light that creates unique patterns on the floor and walls. To optimize beam intensity use this fixture with a fog machine or other type of special effect smoke.

**Customer Support:** American DJ® provides a toll free customer support line, to provide set up help and to answer any question should you encounter problems during your set up or initial operation. You may also visit us on the web at [www.americandj.com](http://www.americandj.com) for any comments or suggestions. For service related issue please contact American DJ®. Service Hours are Monday through Friday 9:00 a.m. to 5:00 p.m. Pacific Standard Time.

Voice: (800) 322-6337

Fax: (323) 582-2941

E-mail: [support@americandj.com](mailto:support@americandj.com)

To purchase parts online visit <http://parts.americandj.com>

**Unpacking:** Every Mini Mace™ has been thoroughly tested and has been shipped in perfect operating condition. Carefully check the shipping carton for damage that may have occurred during shipping. If the carton appears to be damaged, carefully inspect your unit for damage and be sure all accessories necessary to operate the unit have arrived intact. In the event damage has been found or parts are missing, please contact our toll free customer support number for further instructions. Please do not return this unit to your dealer without first contacting customer support at the number listed below.

**Warning!** To prevent or reduce the risk of electrical shock or fire, do not expose this unit to rain or moisture.

**Caution!** There are no user serviceable parts inside this unit. Do not attempt any repairs yourself, doing so will void your manufactures warranty. In the unlikely event your unit may require service please contact American DJ®.

**PLEASE recycle the shipping carton when ever possible.**

## Mini Mace™

## Features

- Two Moving Heads
- Easy Lamp Replacement
- Compact High-Tech Case Design
- Built-In Hanging Base
- Light Weight Case Design
- Multi-Colored Beams
- 30 Multi-Colored Lenses
- 2 x LC-100 120v/100w Lamps or 2 x LC-100 220v/100w

## Mini Mace™

## Warranty Registration

The Mini Mace™ carries a 90 Day limited warranty. Please fill out the enclosed warranty card to validate your purchase. All returned service items whether under warranty or not, must be freight pre-paid and accompany a return authorization (R.A.) number. The R.A. number must be clearly written on the outside of the return package. A brief description of the problem as well as the R.A. number must also be written down on a piece of paper included in the shipping carton. If the unit is under warranty, you must provide a copy of your proof of purchase invoice. You may obtain a R.A. number by contacting our customer support team on our toll free customer support number. All packages returned to the service department not displaying a R.A. number on the outside of the package will be returned to the shipper.

## Mini Mace™

## Precautions

- Keep the outside of this device dry at all times. Do not spill water or other liquids into or on to your unit. To prevent fire or shock hazard, do not expose this product to rain or moisture.
- This unit is designed for interior use only. Do not use this unit out doors. Use of product outdoors will void the warranty.
- Be sure that the local power outlet match that of the required voltage for your unit.
- Never attempt to operate this unit if the power cord becomes frayed or broken.
- Never attempt to operate this unit, if it becomes damaged in any way.
- Do not attempt to remove or break off the ground prong from the electrical cord. This prong is used to reduce the risk of electrical shock and fire in the rare case of an internal short.

## Mini Mace™

## General Instructions

Please carefully read and understand the instructions in this manual thoroughly before attempting to operate this unit. These instructions contain important safety information regarding the use and maintenance of this unit. Please keep this manual with the unit, for future reference.

## Mini Mace™

## Operation

**Power Supply:** Before plugging your unit in, be sure the source voltage in your area matches the required voltage for your American DJ® Mini Mace™ before attempting operation.

**General Operation:** Just plug this light in, and watch it go. This fixture is designed to operate as a stand alone unit. It has been tested and the lamp has been installed at the factory there is no assembly necessary. The Mini Mace™ is ready to be plugged in, out of the box. There is no power switch, after plugging the unit in the base and two outer heads will immediately begin to spin.

## Mini Mace™

## Cleaning

**Fixture Cleaning:** Due to fog residue, smoke, and dust cleaning the internal and external lenses should be carried out periodically to optimize light output. Cleaning frequency depends on the environment in which the fixture operates (I.e. smoke, fog residue, dust, dew). In heavy use we recommend cleaning on a monthly basis. Periodic cleaning will ensure longevity, and crisp beam output.

1. Use normal glass cleaner and a soft cloth to wipe down the outside casing.
2. Use a soft brush to clean out the air vents
3. Clean the external optics with glass cleaner and a soft cloth every 20 days.
4. Clean the internal optics with glass cleaner and a soft cloth every 30-60 days.
5. Always be sure to dry all parts completely before plugging the unit back in.

**Breaker Reset:** This unit is equipped with a safety breaker. This breaker is designed to close the power circuit in the event of an internal short, reducing the risk of electric shock and fire. To reset the breaker, push the breaker button in until you hear it pop back in to place. If the breaker continues to pop, stop using the unit and contact customer support the unit may require service.

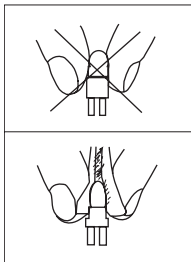

**Halogen Lamp Warning!** This fixture is fitted with halogen lamps which are highly susceptible to damage if improperly handled. Never touch the lamps with your bare fingers as the oil from your hands will shorten lamp life. Also, never move the fixture until the lamps have had ample time to cool. Remember, lamps are not covered under warranty conditions.

**Caution:** Always replace with the exact same type lamp and fuse, unless otherwise specified by an authorized American DJ® technician. Replace with anything other than the specified part can damage your unit and will void your manufactures warranty.

**Warning:** If after you have replaced the lamp or fuse and you continue to blow either one, STOP using the unit. Contact customer support for further instructions, you may have to return the unit for servicing. Continuing to use the unit may cause serious damage.

**Lamp Replacement:** Caution! Never open the unit when in use. Always disconnect the main power and allow the fixture ample time to cool before attempting to replace the lamp. Lamp replacement has been made simple by incorporating a remove tray that is retained by a single thumb screws. Again, please remember to always replace with the exact same type lamp.

1. Be sure to follow the proper procedures when handling halogen lamps. Never touch the new lamp with your bare fingers.
2. Unscrew the three thumb screws that secure the outer half of the dome cover to the inner half.
3. Once the thumb screws have been removed, remove the outer half of the dome assembly to expose the lamps.
4. Remove and replace the lamp with an exact match.
5. Reassemble in reverse order.

## 90 Day LIMITED WARRANTY

A. American DJ® hereby warrants, to the original purchaser, American DJ® products to be free of manufacturing defects in material and workmanship for a period of 90 Days from the date of purchase. This warranty shall be valid only if the product is purchased within the United States of America, including possessions and territories. It is the owner's responsibility to establish the date and place of purchase by acceptable evidence, at the time service is sought.

B. For warranty service, send the product only to the American DJ® factory. All shipping charges must be pre-paid. If the requested repairs or service (including parts replacement) are within the terms of this warranty, American DJ® will pay return shipping charges only to a designated point within the United States. If the entire instrument is sent, it must be shipped in its original package. No accessories should be shipped with the product. If any accessories are shipped with the product, American DJ® shall have no liability whatsoever for loss of or damage to any such accessories, nor for the safe return thereof.

C. This warranty is void if the serial number has been altered or removed; if the product is modified in any manner which American DJ® concludes, after inspection, affects the reliability of the product; if the product has been repaired or serviced by anyone other than the American DJ® factory unless prior written authorization was issued to purchaser by American DJ®; if the product is damaged because not properly maintained as set forth in the instruction manual.

D. This is not a service contract, and this warranty does not include maintenance, cleaning or periodic check-up. During the period specified above, American DJ® will replace defective parts at its expense, and will absorb all expenses for warranty service and repair labor by reason of defects in material or workmanship. The sole responsibility of American DJ® under this warranty shall be limited to the repair of the product, or replacement thereof, including parts, at the sole discretion of American DJ®. All products covered by this warranty were manufactured after January 1, 1990, and bear identifying marks to that effect.

E. American DJ® reserves the right to make changes in design and/or improvements upon its products without any obligation to include these changes in any products theretofore manufactured.

F. No warranty, whether expressed or implied, is given or made with respect to any accessory supplied with products described above. Except to the extent prohibited by applicable law, all implied warranties made by American DJ® in connection with this product, including warranties of merchantability or fitness, are limited in duration to the warranty period set forth above. And no warranties, whether expressed or implied, including warranties of merchantability or fitness, shall apply to this product after said period has expired. The consumer's and or Dealer's sole remedy shall be such repair or replacement as is expressly provided above; and under no circumstances shall American DJ® be liable for any loss or damage, direct or consequential, arising out of the use of, or inability to use, this product.

G. This warranty is the only written warranty applicable to American DJ® Products and supersedes all prior warranties and written descriptions of warranty terms and conditions heretofore published.

H. Lamps are not covered under this or any other warranty either written or implied.

**Model: Mini Mace™**

<b>Voltage*:</b>	120v~60Hz or 220v~50/60Hz
<b>Lamps:</b>	2 x LC-100 120v/100w or 2 x LC-100 220v/100w
<b>Breaker:</b>	3 Amp (2 Amp 220v)
<b>Dimensions:</b>	8.5" (L) x 16" (W) x 9" (H)
<b>Colors:</b>	Multi-Colored Glass Lenses
<b>Working Position:</b>	Any Safe Position Modes
<b>Weight:</b>	6 Lbs.
<b>Duty Cycle**:</b>	No Duty Cycle
<b>Warranty:</b>	90 Days

\* Voltage is preset at the factory and is not user selectable.

\*\* While there is no duty cycle, to save lamp life you can run a duty cycle of your own.

**Please Note:** Specifications and improvements in the design of this unit and this manual are subject to change without any prior written notice.

©American DJ®

American DJ® World Headquarters:

6122 S. Eastern Ave. Los Angeles, CA 90040 USA

Tel: 323-582-2650 / Fax: 323-582-2610

Web: [www.americandj.com](http://www.americandj.com) / E-mail: [info@americandj.com](mailto:info@americandj.com)